

STATE OF NORTH CAROLINA
DEPARTMENT OF TRANSPORTATION
HIGHWAY DIVISION 6

PLANS

Letting Date: November 5, 2025

CONTRACT ID: DF00533

TIP NO.: -----

FEDERAL AID NO.: STATE FUNDED

WBS ELEMENT NO.: 2026CPT.06.07.20431.1

ROUTE NO.: VARIES

LOCATION: VARIES

COUNTY: HARNETT

LENGTH OF PROJECT: 12.49 MILES

TYPE OF WORK: WIDENING, RESURFACING, MILLING & PAVEMENT MARKINGS

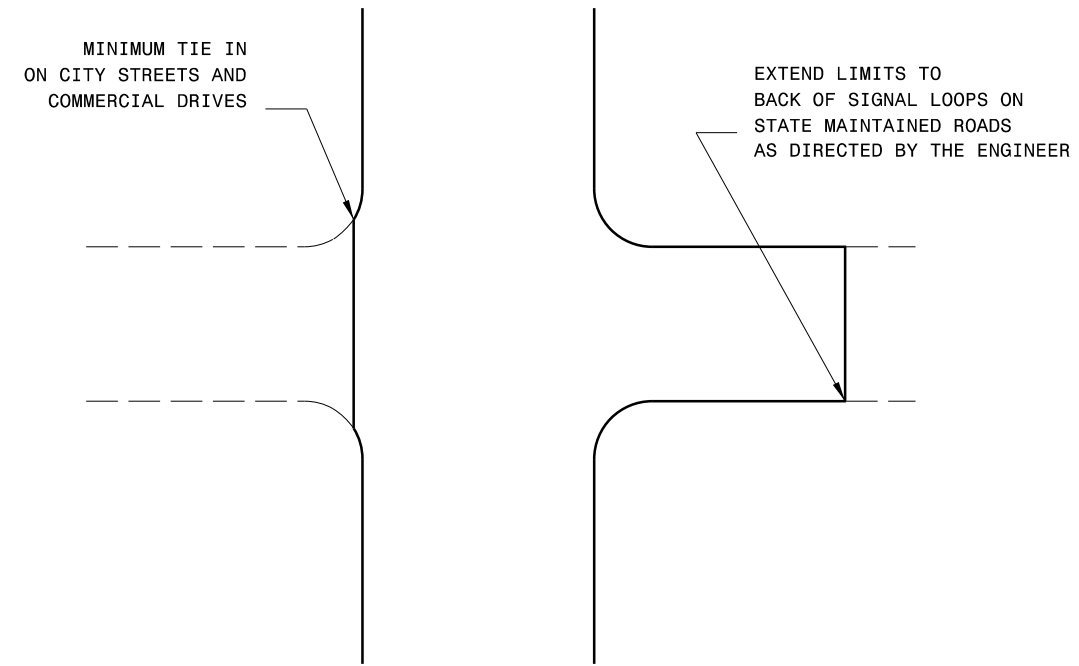

TYPICAL DETAIL OF PROJECT LIMITS AT SIGNALIZED Y LINES

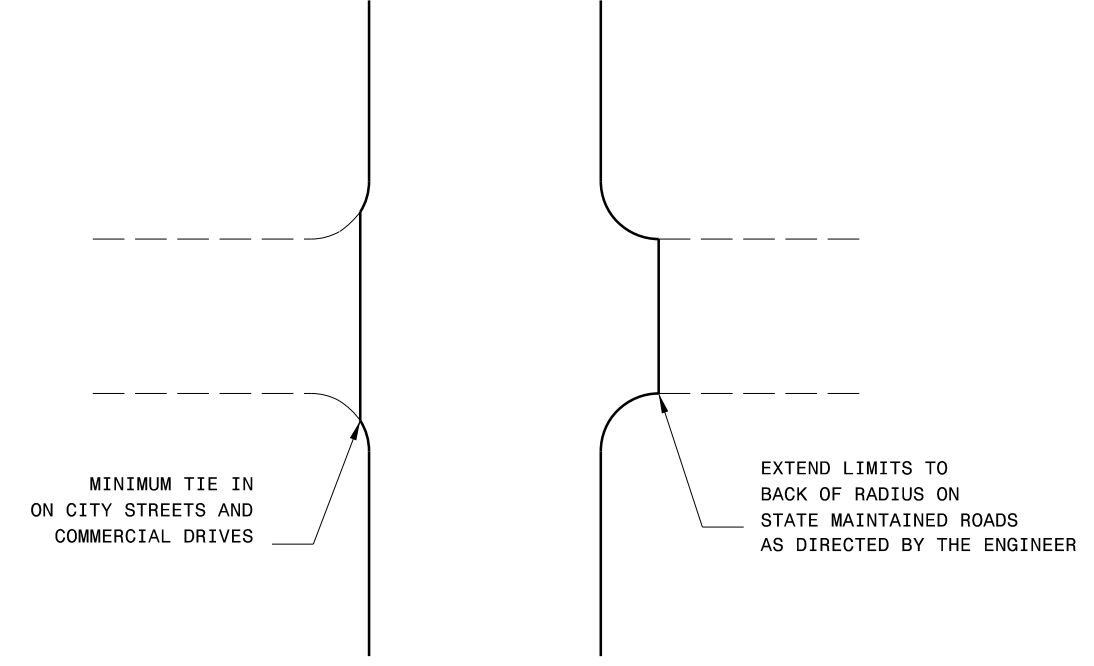

TYPICAL DETAIL OF PROJECT LIMITS AT UNSIGNALIZED Y LINES

ADDITIONAL INTERSECTIONS (NON-TYPICAL)		
Extend paving limits to back of radius or loop on the following intersections:		
MAP#	STREET NAME	COMMENTS
1	SR 1700 RT Williams Rd	56.26 Ft from EP of L-Line 514.21 SY
1	SR 1700 RT Delma Grimmes Rd	95.93 Ft from EP of L-Line 1051.39 SY
2	SR 1705 LT Tilghman Rd	90 Ft from EP of L-Line 1241.8 SY
2	SR 1705 RT Tilghman Rd	90 Ft from EP of L-Line 1241.8 SY
2	SR 1705 LT Rudolph Rd	63 Ft from EP of L-Line 376.81 SY
2	SR 1705 LT Hobson Rd	46.38 Ft from EP of L-Line 486.68 SY
2	SR 1705 LT Brinkley Rd	35 Ft from EP of L-Line 228.93 SY
2	SR 1705 LT Partin Rd	44.57 Ft from EP of L-Line 368.59 SY
2	SR 1705 RT 3 Bridge Rd	60.10 Ft from EP of L-Line 629.7 SY
5	SR 2036 LT Fire Lane	78.47 Ft from EP of L-Line 1091.43 SY
5	SR 2036 LT Hamilton Rd	95.58 Ft from EP of L-Line 1255.60 SY
6	SR 2038 LT Temple Rd	40.72 Ft from EP of L-Line 341.91 SY
6	SR 2038 RT Templar Rd	40.72 Ft from EP of L-Line 341.91 SY

- NOTES:
- 1) DETAIL DOES NOT APPLY TO OGAFD AND ULTRA-THIN BONDED WEARING COURSE.
 - 2) BACKFILL SHOULDER WITH APPROVED MATERIAL.
 - 3) THE SHOULDER WEDGE DEVICE MAY BE DISENGAGED AT PAVED DRIVEWAYS AND SIDE STREETS.

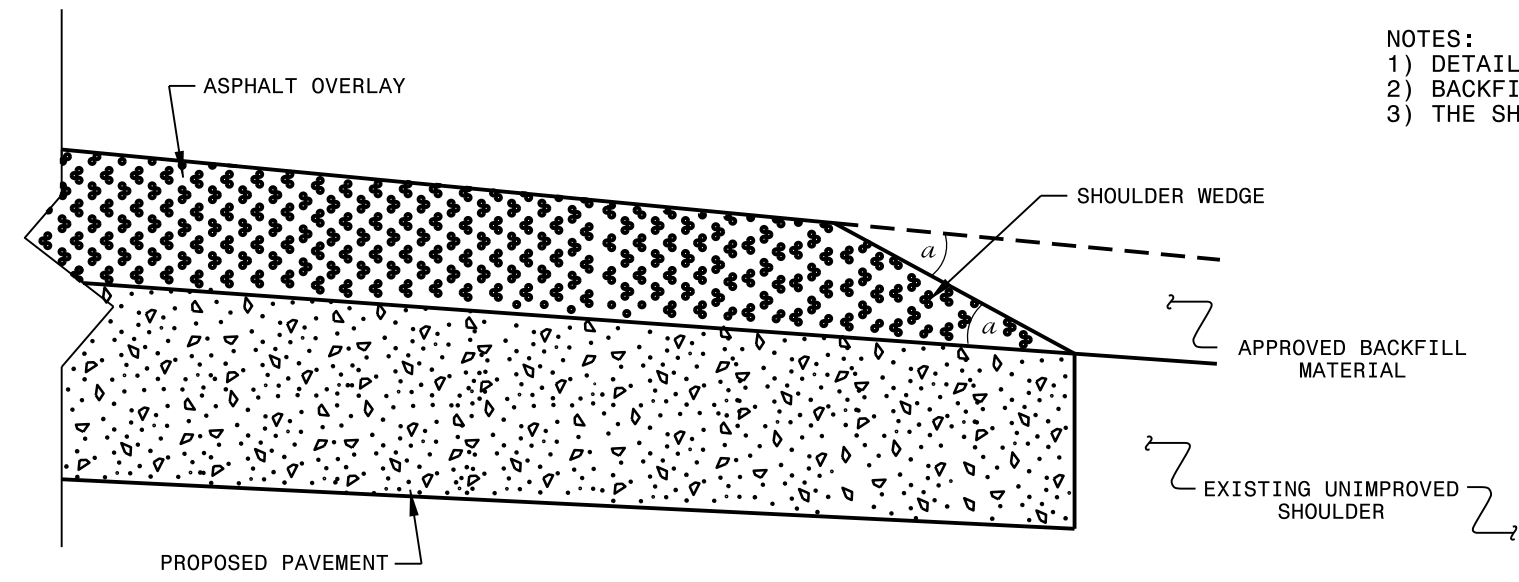

SHOULDER WEDGE DETAIL
 (Resurfacing Projects w/ Widening or
 with Existing Paved Shoulder having no dropoffs)

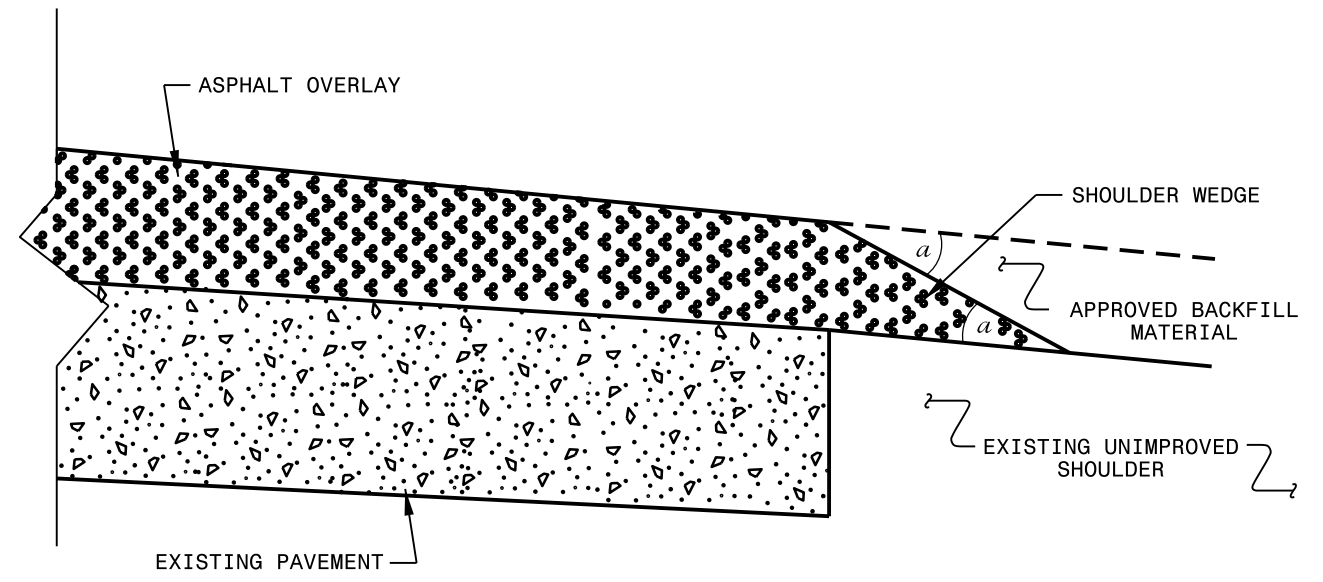

SHOULDER WEDGE DETAIL
 (Resurfacing Projects w/ NO Widening)

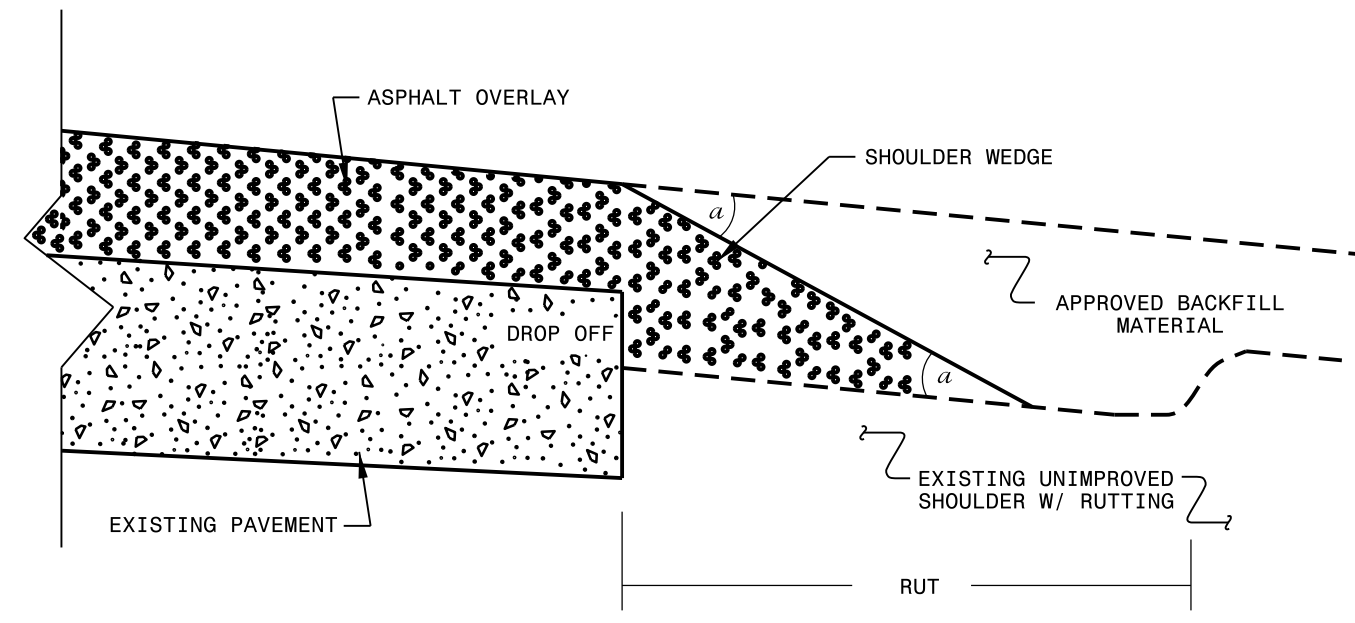

SHOULDER WEDGE DETAIL
 (Resurfacing Adjacent to
 Rutted Shoulder)

- SHOULDER WEDGE ANGLE = 30°

CONTRACT STANDARDS
 AND DEVELOPMENT UNIT
 Office 919-707-6950 FAX 919-250-4119

**SHOULDER WEDGE
 DETAILS**

ORIGINAL BY: T.SPELL DATE: 7-19-11
 MODIFIED BY: DATE: 10/16/12
 CHECKED BY: DATE:
 FILE SPEC.: susr/details/stand/shoulderwedgedetail.dgn

SYSTEMS DESIGN
 USER NAME

SIGNING FOR RESURFACING PROJECTS

LEGEND
 ┆ STATIONARY SIGN
 ← DIRECTION OF TRAFFIC FLOW

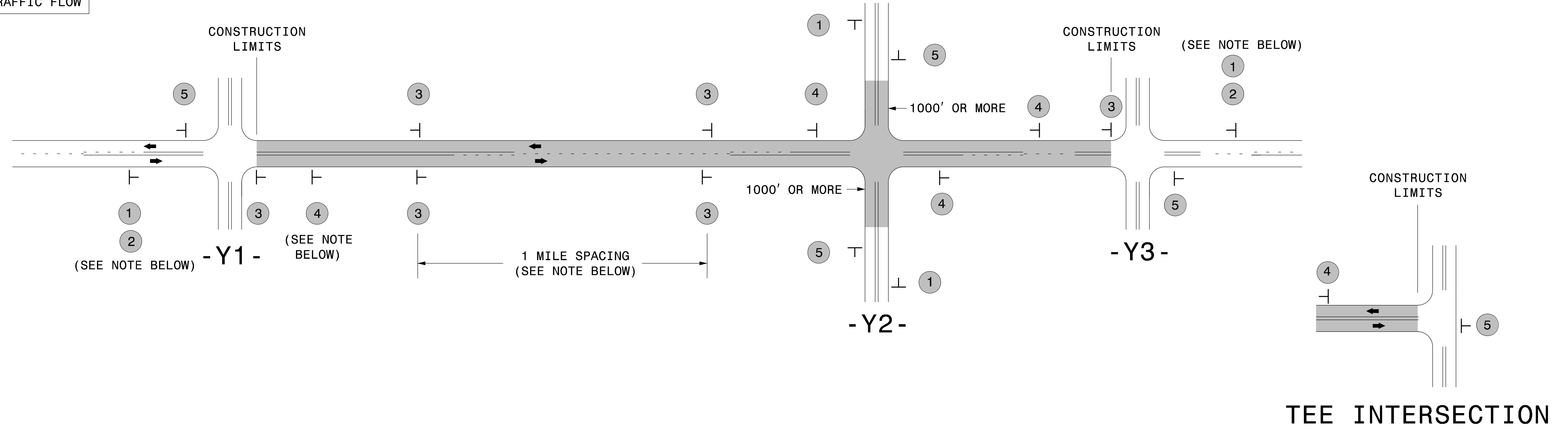

MAINLINE (-L-) SIGNING

-Y- LINE SIGNING

SIGNING NOTES AND PLACEMENT PER DIRECTION	1	 W20-1 48" X 48"	PLACE 1000' PRIOR TO BEGINNING OF CONSTRUCTION LIMITS. ONLY USED ON -Y- LINES IF RESURFACING LIMITS EXTEND 1000' ALONG -Y- LINE.	<p>NO REQUIRED STATIONARY SIGNING FOR THE FOLLOWING -Y- LINE CONDITIONS:</p> <ol style="list-style-type: none"> 1) LESS THAN 1000' OF RESURFACING ALONG -Y- LINE 2) SUBDIVISION ROADS 3) DEAD END ROADS <p>WHEN PAVING/CONSTRUCTION ACTIVITIES PROCEED ACROSS AN UNSIGNED -Y- LINE, PORTABLE ADVANCE WARNING SIGNS SHALL BE USED ALONG THE -Y- LINE AS SHOWN BELOW. REMOVE UPON COMPLETION OF WORK.</p> <div style="display: flex; justify-content: space-around;"> <div style="text-align: center;"> W20-1 48" X 48" PLACED 500' IN ADVANCE OF FLAGGER. </div> <div style="text-align: center;"> W20-7 A 48" X 48" PLACED 250' IN ADVANCE OF FLAGGER. </div> </div>
	2	 W7-3aP 24" X 18"	#2 SIGN ONLY USED WHEN CONSTRUCTION LIMITS ARE 2 OR MORE MILES IN LENGTH. ROUND UP TO NEXT WHOLE NUMBER. (NO FRACTIONAL OR DECIMAL NUMBERS)	
	3	 SP 13107 48" X 48"	<ul style="list-style-type: none"> - PLACE INITIALLY AT THE CONSTRUCTION LIMITS AND SPACE 1 MILE APART THEREAFTER. - AT TEE INTERSECTIONS INSTALL INITIALLY 1/2 MILE FROM INTERSECTION AND SPACE 1 MILE APART THEREAFTER. 	
	4	 SP 13106 48" X 48"	<ul style="list-style-type: none"> - THESE ARE FOR -Y- LINES THAT ARE "THROUGH" ROADWAYS. - DEAD END AND SUBDIVISION ROADS ARE NOT "THROUGH" ROADWAYS. - INSTALL 500' +/- FROM EACH -Y- LINE APPROACH AS SHOWN ABOVE. - FOR MULTIPLE -Y- LINES THAT ARE SEPARATED BY 0.25 MILES OR LESS, TREAT AS A SINGLE UNIT AND INSTALL WITHIN 500' OF EACH APPROACH. - A MAXIMUM OF 2 SIGN SETS PER MILE. DO NOT INSTALL WHEN -Y- LINES ARE WITHIN 0.5 MILES FROM "END ROAD WORK" SIGN. - FOR TEE INTERSECTIONS, INSTALL WITHIN 500' +/- OF THE INTERSECTION ALONG -L- LINE. 	
	5	 G20-2 A 48" X 24"	PLACE 500' FOLLOWING THE END OF CONSTRUCTION LIMITS OR AS SHOWN WHEN WORK ENDS AT A 3-WAY TEE INTERSECTION.	

THE ABOVE SIGNS ARE ALL THAT ARE REQUIRED FOR A CONTRACTOR TO BEGIN A RESURFACING CONTRACT. ANY ADDITIONAL SIGNS REQUESTED BY NCDOT DIVISIONS SHALL BE INSTALLED WITHIN 7 BUSINESS DAYS OF THE START OF CONTRACT WORK.

MAPS LESS THAN 2 MILES

FOR RESURFACING MAPS WITH CONSTRUCTION LIMITS LESS THAN 2 MILES IN LENGTH, NO STATIONARY SIGNS ARE REQUIRED. USE PORTABLE "ROAD UNDER CONSTRUCTION" OR "ROAD WORK AHEAD" SIGNS IN LIEU OF STATIONARY ADVANCE WARNINGS SIGNS.

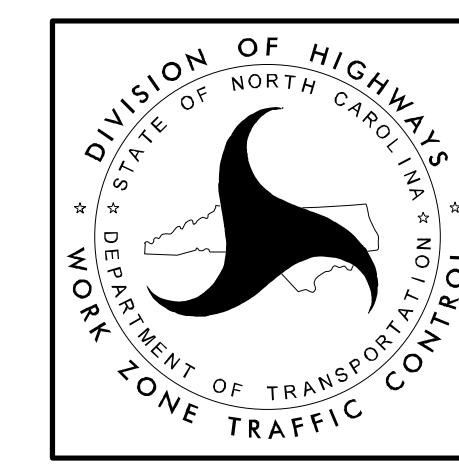

ADVANCE WARNING SIGNS FOR RURAL AND SUBURBAN 2-LANE ROADWAY RESURFACING

GUIDELINES FOR LANE WIDTHS ON RESURFACING PROJECTS

Contractor shall place the new pavement markings in accordance with this table and detail unless otherwise directed by the Engineer.

TWO LANE - TWO WAY ROADWAY - 55 MPH		
ROADWAY WIDTH	LANE WIDTH	SHOULDER WIDTH
18'	9' *	0'
20'	10' *	0'
22'	10'	1'
24'	10'	2'
26'	11'	2'
28'	12'	2'
32'	12'	4'

* May vary due to pavement width

TWO LANE - TWO WAY ROADWAY		50
MPH OR LESS		
ROADWAY WIDTH	LANE WIDTH	SHOULDER WIDTH
18'	9' *	0'
20'	10' *	0'
22'	10'	1'
24'	10'	2'
26'	11'	2'
28'	11'	3'
32'	11'	5'

* May vary due to pavement width

SCHEMATIC OF ROADWAY

(NOT TO SCALE)

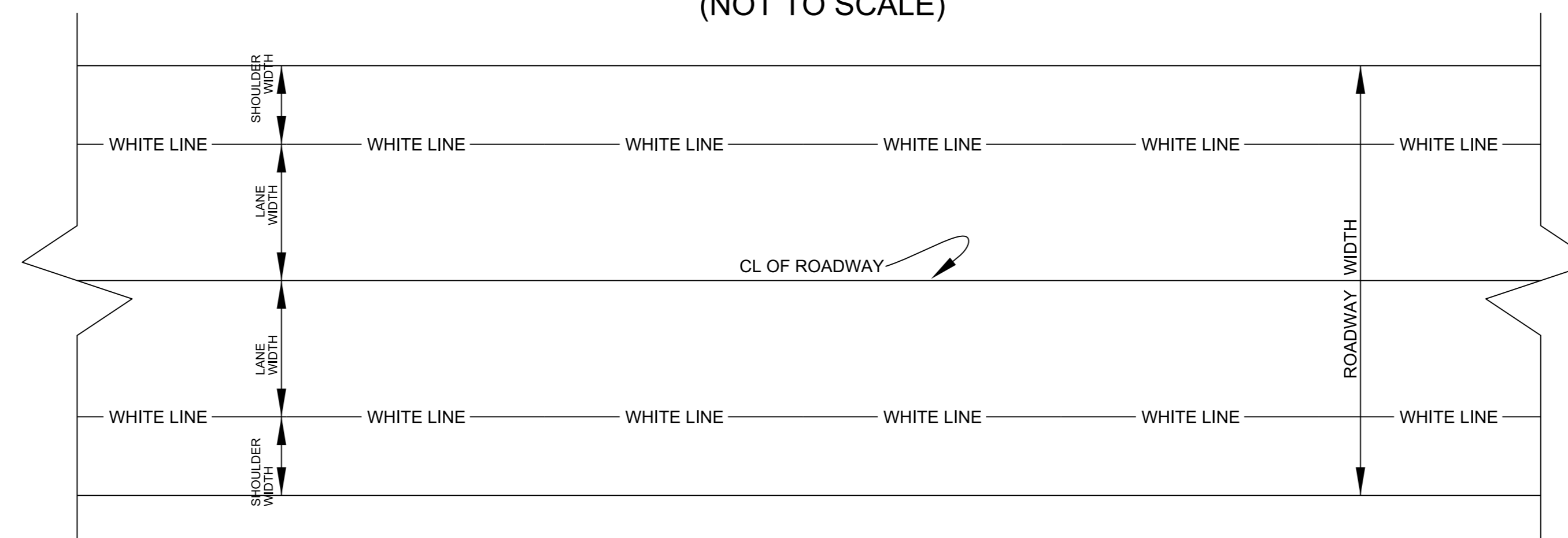

PROJECT NO.	SHEET NO.	TOTAL NO.
2026CPT.06.07.20431.1		

SUMMARY OF QUANTITIES

PROJECT NO	COUNTY	MAP NO	ROUTE	DESCRIPTION	TYP NO	LANES	LANE TYPE	LENGTH	WIDTH	BEG N	END MP	1220000000-E	1245000000-E	1260000000-E	1297000000-E	1330000000-E	1491000000-E	1519000000-E	1575000000-E	1704000000-E	2830000000-N	2845000000-N
												INCIDENTAL STONE BASE	SHOULDER RECONSTRUCTION	AGGREGATE SHOULDER BORROW	1½" MILLING	INCIDENTAL MILLING	BASE COURSE, B25.0C	SURFACE COURSE, S9.5B	ASPHALT BINDER FOR PLANT MIX	PATCHING EXISTING PAVEMENT	ADJ. OF MANHOLES	ADJ. OF METER OR VALVE BOX
								MI	FT			TONS	SMI	TON	SY	SY	TONS	TONS	TONS	TONS	EA	EA
2026CPT.06.07.20431.1	Harnett	1	SR-1700 / CANE MILL RD	FROM COATS CL TO NC 55	1 & 2	2	2WU	1.64	24	2.16	3.8	133	3.20	517	3,285	556	33	2,188	147		10	10
TOTAL FOR MAP NO. 1								1.64				133	3.20	517	3,285	556	33	2,188	147		10	10
2026CPT.06.07.20431.1	Harnett	2	SR-1705 / FAIRGROUND RD	FROM NC 27 TO SR1714	1	2	2WU	3.75	22	0	3.75	167	7.50	1,213		1,944		4,166	280	2		
TOTAL FOR MAP NO. 2								3.75				167	7.50	1,213		1,944		4,166	280	2		
2026CPT.06.07.20431.1	Harnett	3	SR-1740 / BAIT RD	FROM RAIFORD RD TO SR 1735	1	2	2WU	0.64	19	0	0.64	35	1.27	206		556		634	43	2		
TOTAL FOR MAP NO. 3								0.64				35	1.27	206		556		634	43	2		
2026CPT.06.07.20431.1	Harnett	4	SR-1815 / COUNTY AVE	FROM US421 TO SR 1735	1	2	2WU	0.41	21	0	0.41	17	0.82	133		556		466	32	4	1	
TOTAL FOR MAP NO. 4								0.41				17	0.82	133		556		466	32	4	1	
2026CPT.06.07.20431.1	Harnett	5	SR-2036 / THOMPSON RD	FROM SR2030 TO SR2072	1	2	2WU	3.54	20	0	3.54	108	7.20	1,164		1,444		3,584	241	8		
TOTAL FOR MAP NO. 5								3.54				108	7.20	1,164		1,444		3,584	241	8		
2026CPT.06.07.20431.1	Harnett	6	SR-2038 / FIRE LANE RD	FROM NC 210 TO SR2036	1	2	2WU	1.32	20	0	1.32	50	2.64	427		722		1,327	91	36		
TOTAL FOR MAP NO. 6								1.32				50	2.64	427		722		1,327	91	36		
2026CPT.06.07.20431.1	Harnett	7	SR-2084 /	FROM PAVMENT CHANGE TO NC27	1	2	2WU	1.19	23	0.78	1.97	33	2.40	388		1,806		1,460	99	2		
TOTAL FOR MAP NO. 7								1.19				33	2.40	388		1,806		1,460	99	2		
TOTAL FOR PROJ NO. 2026CPT.06.07.20431.1								12.49				543	25.03	4,048	3,285	7,584	33	13,825	933	54	11	10
GRAND TOTAL								12.49				543	25.03	4,048	3,285	7,584	33	13,825	933	54	11	10

PROJECT NO.	SHEET NO.	TOTAL NO.
2026CPT.06.07.20431.1		

THERMOPLASTIC AND PAINT QUANTITIES

PROJECT NO	COUNTY	MAP NO	ROUTE	DESCRIPTION	TYP NO	LANES	LANE TYPE	LENGTH	WIDTH	BEGIN MP	END MP	4413000000-E	4457000000-N	4685000000-E		4709000000-E	4900000000-N
												WORK ZONE ADVANCE/GE NERAL WARNING SIGNING	TEMPORARY TRAFFIC CONTROL	4" X 90 M WHITE THERMO	4" X 90 M YELLOW THERMO	24" X 90 M WHITE THERMO	YELLOW & YELLOW MARKERS
								MI	FT	SF	LS	LF	LF	LF	EA		
2026CPT.06.07.20431.1	Harnett	1	SR-1700 / CANE MILL RD	FROM COATS CL TO NC 55	1 & 2	2	2WU	1.64	24	2.16	3.8	305	1.00	16,150	17,500	50	120
TOTAL FOR MAP NO. 1								1.64				305	1	16,150	17,500	50	120
2026CPT.06.07.20431.1	Harnett	2	SR-1705 / FAIRGROUND RD	FROM NC 27 TO SR1714	1	2	2WU	3.75	22	0	3.75	420		32,500	35,500	50	250
TOTAL FOR MAP NO. 2								3.75				420		32,500	35,500	50	250
2026CPT.06.07.20431.1	Harnett	3	SR-1740 / BAIT RD	FROM RAIFORD RD TO SR 1735	1	2	2WU	0.64	19	0	0.64	71					
TOTAL FOR MAP NO. 3								0.64				71					
2026CPT.06.07.20431.1	Harnett	4	SR-1815 / COUNTY AVE	FROM US421 TO SR 1735	1	2	2WU	0.41	21	0	0.41	46		4,350	3,250		35
TOTAL FOR MAP NO. 4								0.41				46		4,350	3,250		35
2026CPT.06.07.20431.1	Harnett	5	SR-2036 / THOMPSON RD	FROM SR2030 TO SR2072	1	2	2WU	3.54	20	0	3.54	403		37,500	28,225		245
TOTAL FOR MAP NO. 5								3.54				403		37,500	28,225		245
2026CPT.06.07.20431.1	Harnett	6	SR-2038 / FIRE LANE RD	FROM NC 210 TO SR2036	1	2	2WU	1.32	20	0	1.32	148		12,700	9,600		100
TOTAL FOR MAP NO. 6								1.32				148		12,700	9,600		100
2026CPT.06.07.20431.1	Harnett	7	SR-2084 /	FROM PAVMENT CHANGE TO NC27	1	2	2WU	1.19	23	0.78	1.97	134		12,750	9,650		85
TOTAL FOR MAP NO. 7								1.19				134		12,750	9,650		85
TOTAL FOR PROJ NO. 2026CPT.06.07.20431.1								12.49				1,527	1.000	115,950	103,725	100	835
														219,675			
GRAND TOTAL								12.49				1,527	1.000	115,950	103,725	100	835
														219,675			